



- Water-resistant probe with sapphire window
- Single power supply
- Analog 0-5 V or 4-20 mA output
- High sensitivity and proven reliability



UV lamp monitoring, UV power measurement for waste/ballast water sterilization, UV curing process control, UV phototherapy monitoring

General parameters				
Dimensions	Window diameter (mm)	Weight (g)	Case material	
See drawing below	8	165	316L	
Parameters	Symbol	Value	Unit	Remark
Operation temperature	T_{opt}	-30-85	°C	
Storage temperature	T_{sto}	-40-90	°C	
Water resistance	p	>10	bar	entrance window side
Supply voltage	V_{cc}	9-24	V	DC
Output signal	I_{out}	4-20	mA	2 wire circuit (WP-UVx-G3/4-31)
				3 wire circuit (WP-UVx-G3/4-32)
	V_{out}	0-5	V	3 wire circuit (WP-UVx-G3/4-33)
Detection wavelength range ¹	λ	220-280	nm	WP-UVC-G3/4-3y
		220-325		WP-UVB-G3/4-3y
		220-370		WP-UVA-G3/4-3y
		290-440		WP-UVV-G3/4-3y
UV power intensity measurement range	P	0-200	mW/cm ²	See other options ²
Circular connector	5 mm male connector with 5 pins			
Cable (optional)	2 m cable with 5 mm female connector (cable length can be customized)			

¹ UVA, UVB, UVC, UVV and full UV band are all available upon request.

² UV power intensity measurement range: 0-200 mW/cm² (standard), 0-1 W/cm² (option), 0-10 W/cm² (option), 0-40 W/cm² (option).

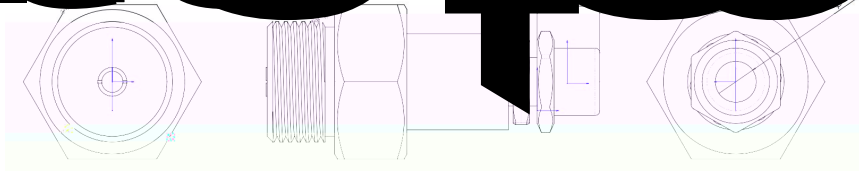

Circular connector:

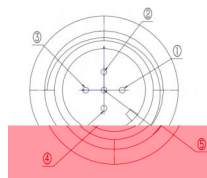
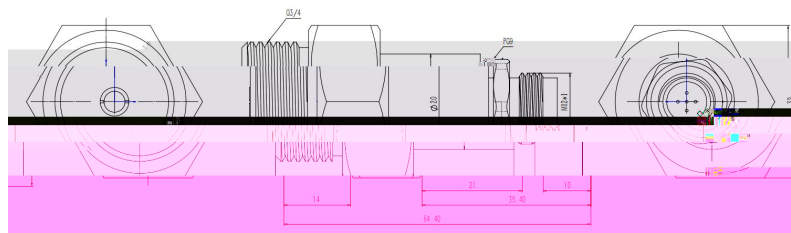

connector view
5 pin M 12x1
RSFM5

5-pin analog plug:

pin 1= V_{CC} , pin 2=null,
pin 3= V_{in} / V_{out} , pin 4=GND / null,
pin 5=null

- Fully compatible with all GaNo Opto's UV sensor probes
- Real time display of UV power density, UV source accumulated service time and UV source output efficiency
- System settings for UV output calibration, timer reset, operation status cartographer